

Smart Camera Instruction

Download Yi IoT app

Scan QR code below



Search and download
Yi IoT app
In Google play



In App store



Sign up and log in

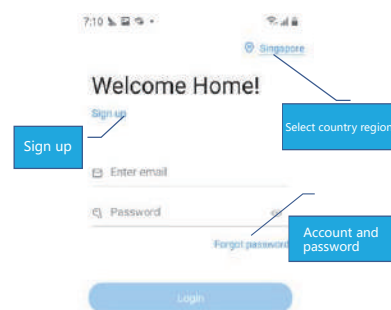

How to add camera

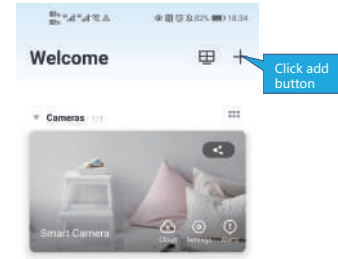

How to connect with WiFi

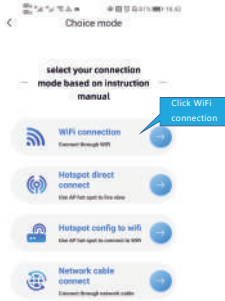

How to watch via hotspot

Step 1/5 Click 'Hotspot direct connect'

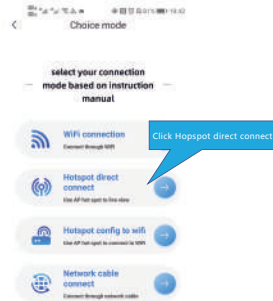

Step 2/5 Note description and connect signal of camera

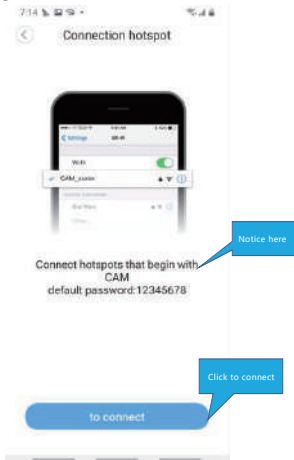

Step 3/5 Connect signal begin with 'CAM_' in phone setting

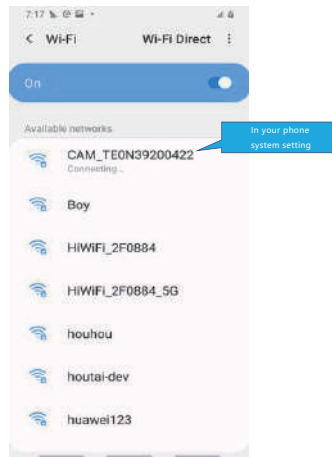

Step 4/5 Back to app, camera is connected

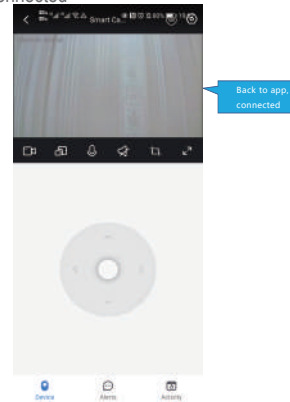

How to get online via hotspot

Step 1/3 Click 'Hotspot config to wifi'

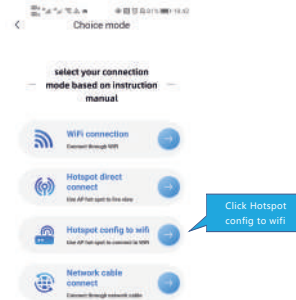

Step 2/3 Connect to wifi and click Next

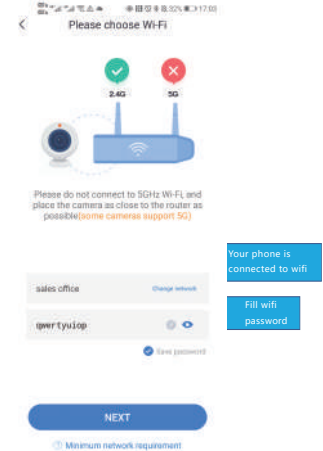

Step 3/3 Pairing successful

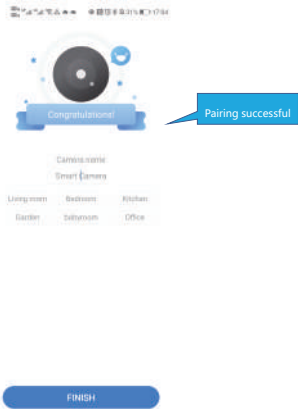

Pairing successful

How to connect with network cable

Step1/5 Click 'Network cable connect'



Click Network cable connect

Step4/5 Waiting for pairing

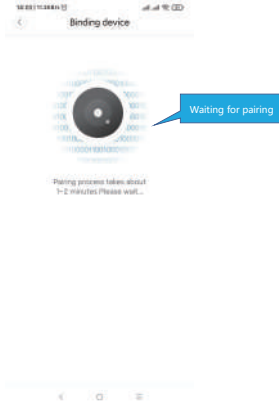

Waiting for pairing

Step 5/5 Pairing successful

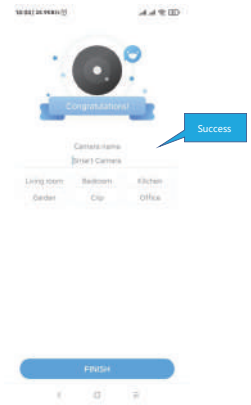

Success

Step2/5 Note description and click Next



Notice and click Next

Step3/5 Select device and Next



Select device and Next

How to use app

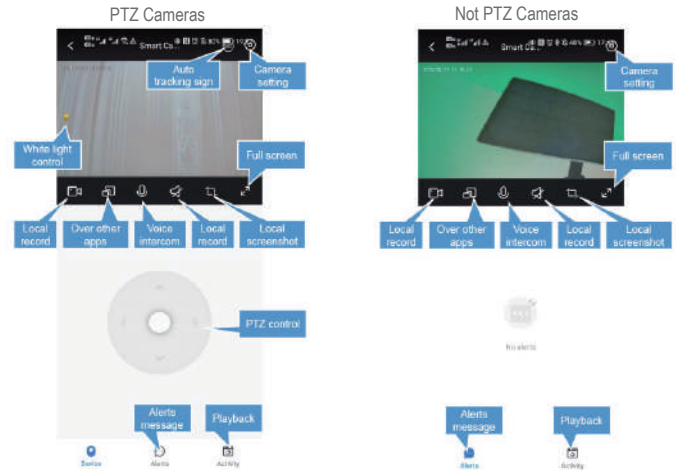

Cloud storage

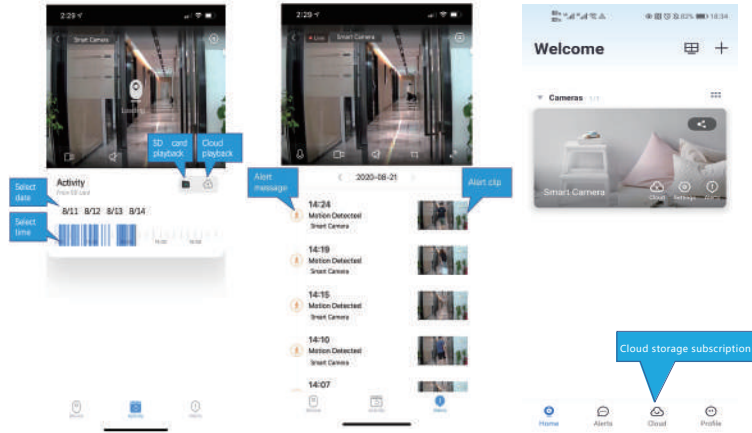

FAQ

Q: The camera is offline .

- 1.Check if the power supply is working properly
- 2.Power off and restart the device to reconnect to the network
- 3.The signal coverage is weak
- 4.Signal interference shielding in special places

Q: How does the camera store video?

- 1.The camera supports the F32 format with a maximum capacity of 128G.
After the card is recognized, it automatically records, and when the storage is full, it automatically overwrites the original recording and loops recording;
- 2.Support opening cloud storage service to store video.

Special statement

The product is subject to the actual product, the instruction manual is for reference only. Mobile phone app and device firmware version support update, users can upgrade through the app.

The manual may contain technical descriptions or inconsistencies with product functions or typographical errors. Our company reserves the right of final interpretation.

Do not install the product in a place where it is damp, dusty, high temperature, flammable or explosive .